

2022 Loveland, COAL Day 2 Written Statement

Thank you for responding to our continuing mine emergency. You are located at the inby fresh air base on the West Mains Section. A 3 member rescue team failed to return to the surface this morning after working last night on removing the seals you encountered yesterday. They were working just inby the new FAB. We have not heard from them. They were wearing SCBA's while attempting to remove the seals. We do know they built at least 1 permanent stopping outby this fresh air base.

The exhausting main mine fan on the surface went down an hour ago and our crews are there attempting to get it operational. You will be notified when it becomes available. Because the main fan is not operational, you can use 3 entry outby the west mains for moving air if necessary.

The two air shafts are useable with a blowing fan on the surface in the #3 entry and a return air shaft in the #1 entry. The blowing fan is currently off and can be started if needed from controls in the command center. It cannot be reversed.

At present, there is no air movement into or out of the West Mains section inby the fresh-air-base or across the fresh air base but we know the air is good.

Back up teams and all officials are on site.

The map is up to date.

2022 Loveland Day 2

Written Problem

Account for the 3 missing miners and bring all live persons to the fresh-air-base.

Explore the entire section if it can be done safely.

Your Team has 100 minutes to complete this problem.

Materials

BC:

Elongated Objects:

Roof/rib markers:

Placards:

Misc:

10

2 x 26' ¼" ropes

Red-6

1 x20' LC

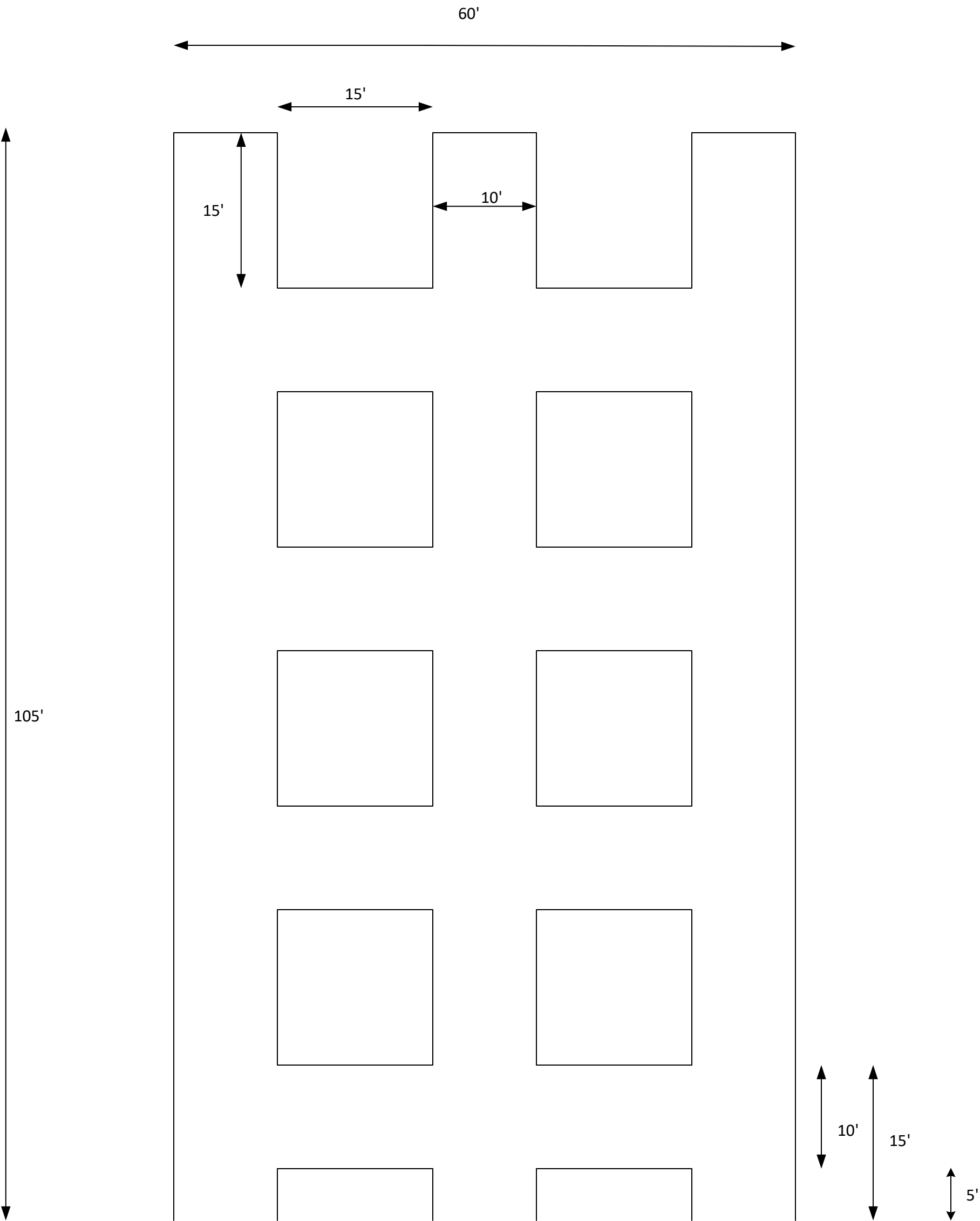

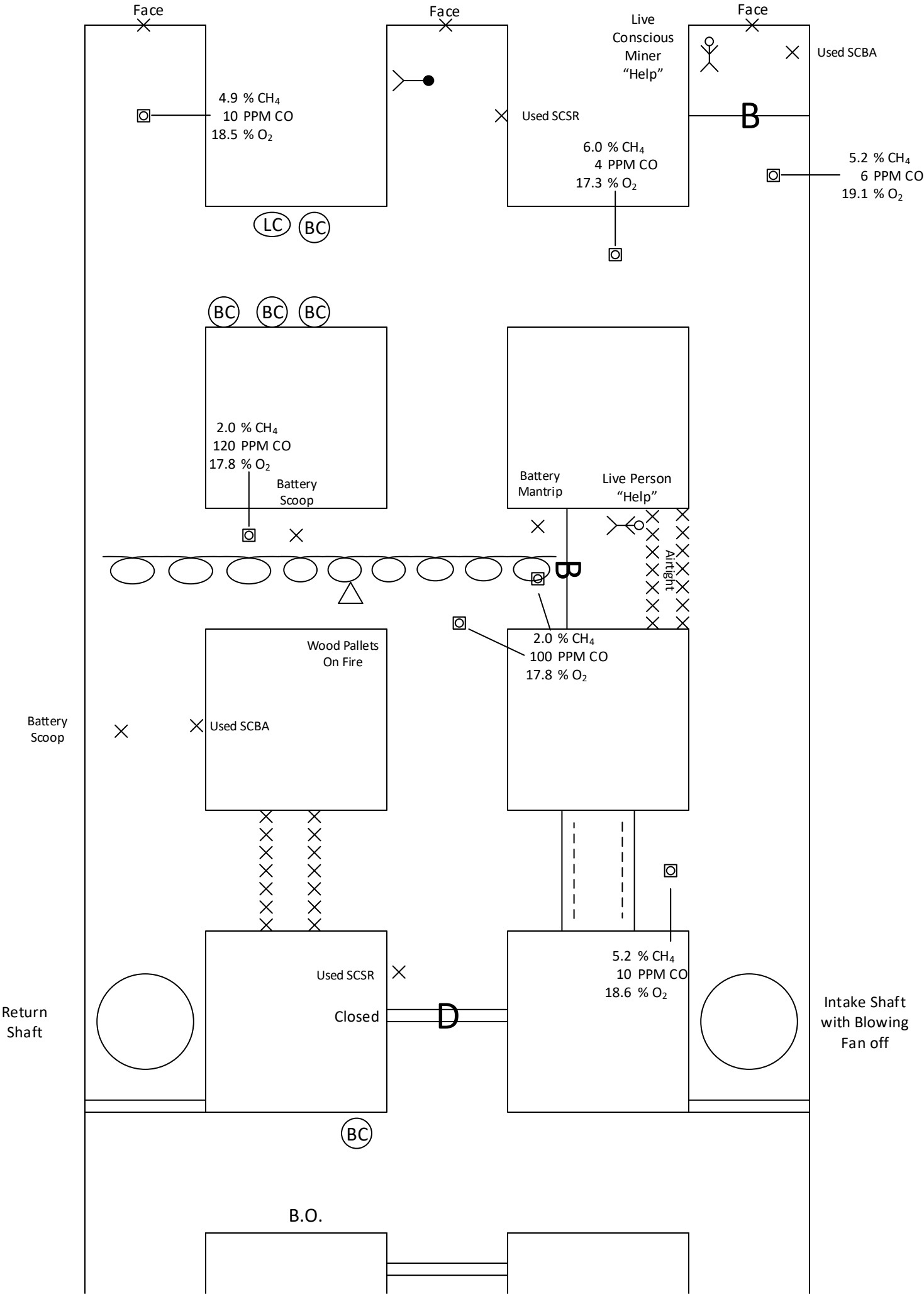

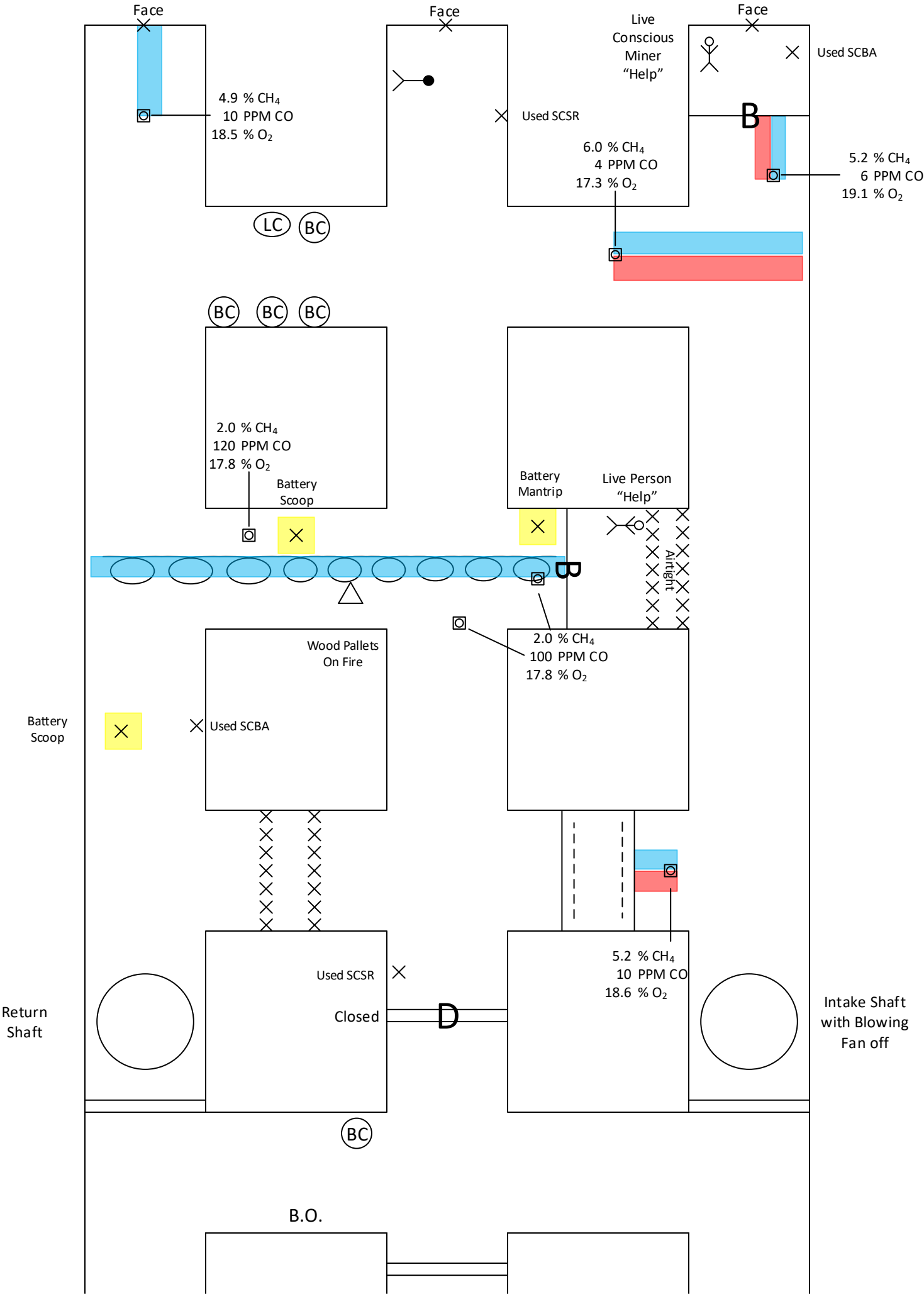

Loveland 2022 Day 2 Judges Instructions

1. Initial opening checks of each entry. Stoppings found in each entry. 50' team app check required when all members inby FAB but can be at stop 1 also. Can airlock into 2 E.
2. Team **stop 1** - (apparatus check required) In 2 entry at XC 1. Caved found to left in XC 1, unsafe roof found to right in XC 2. Can advance in 2 E.
3. Team **stop 2** – in 2 entry at XC 2. IN SMOKE. (Radio teams must set life line) Barricade with response of “help” found to right. Ignition source outby barricade. Extinguishable fire found to left, tem must rr check. Ignition source found to left in XC 2. Not enough information or materials to vent and breach barricade. Must tie across to 1 E.
4. Team **stop 3** – in 1 entry at XC 2. Ignition source found outby, and smoke ends in intersection. Team must tie outby to XC 1 in 1 E.
Team **Stop 4** - in 1 entry at XC 1. Caved found toward 2 E in XC 1. Bottom of return shaft and stopping outby found. Team must advance in to XC 3 in either 1 or 2 E's. (team choice)
5. Team **stop 5,9** – in 2 entry at XC 3. Face of 1 E made. Multiple brattice and LC found in XC 3 to right.
6. Team **stop 6,5** – in 2 entry at XC 3. Face of 2 E made, Body found. Team can tie across to 3 E.
7. Team **stop 6,7** – in 3 entry at XC 3. Barricade found inby XC 3 with response “Help”. Teams do not have enough info/materials to vent.
8. Team **Stop 7,8** – in 3 entry at XC 2. Diagonal RR test required, airtight cave on intersection plane.
9. Team **stop 8,9** – in 3 entry at XC 1. exp mix and unsafe roof found in XC 1, intake shaft and stopping found outby. Team has enough materials and information to vent and breach barricade in XC 2 between 2 and 3 E's.
See Vent 1 Note: build in 2 E inby XC 2 might not be required.
Teams have enough materials to vent and breach barricade in 3 entry.
See Vent 2
Airlocks required prior to breaching either barricade.
Patients don't require respiratory protection and can both be walked to FAB.
End of Problem

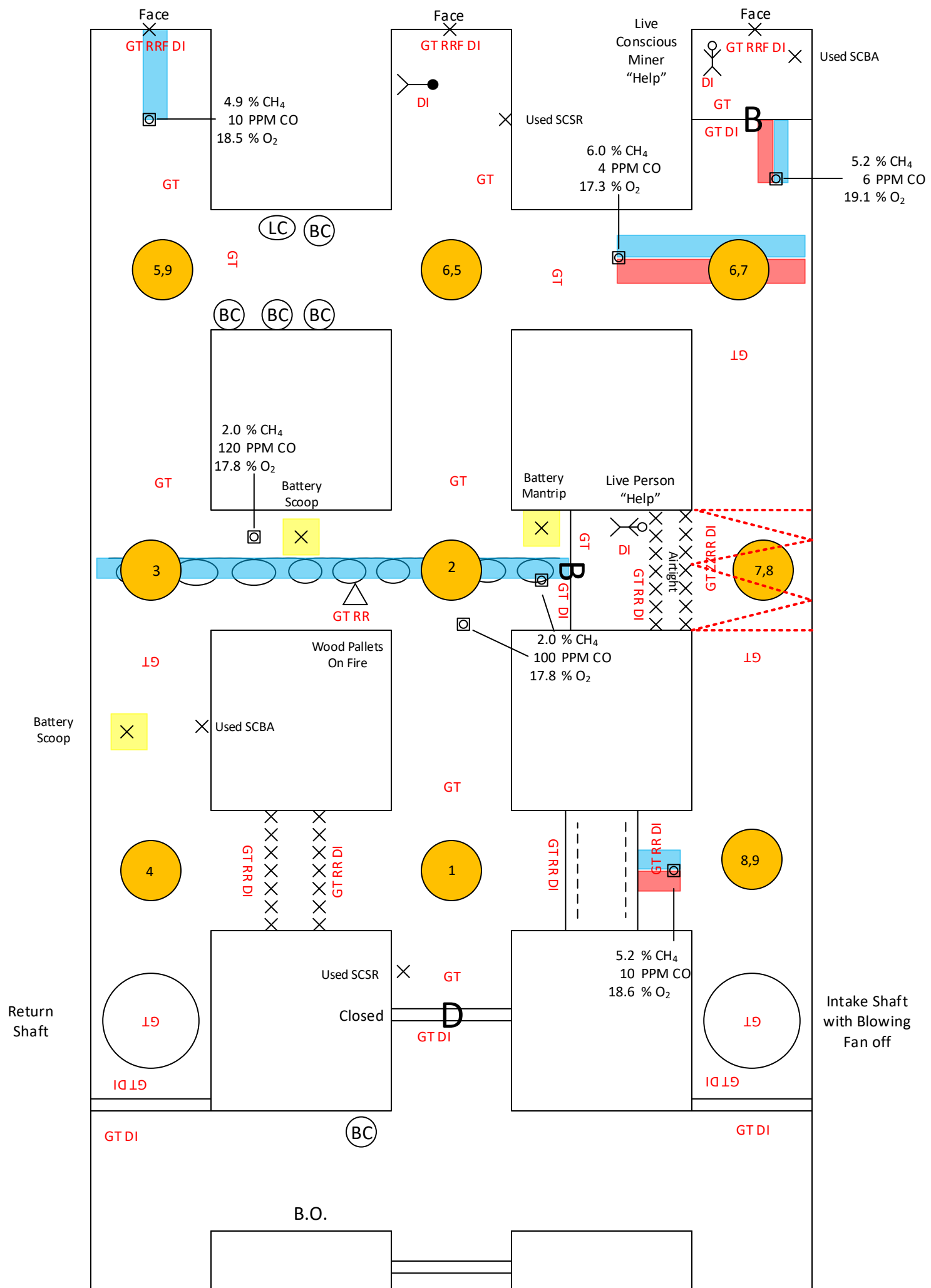

Judges vent map

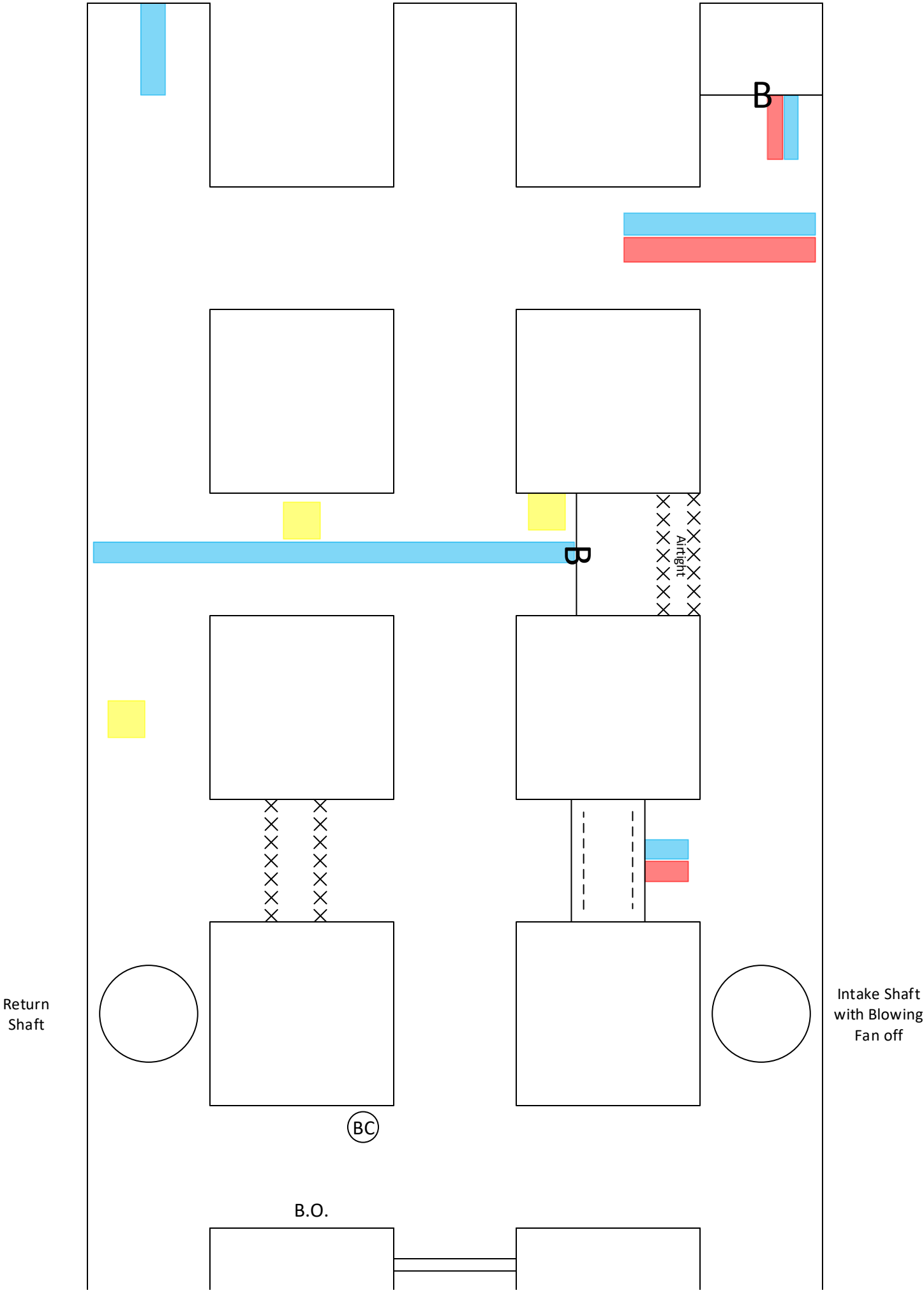

VENT 1

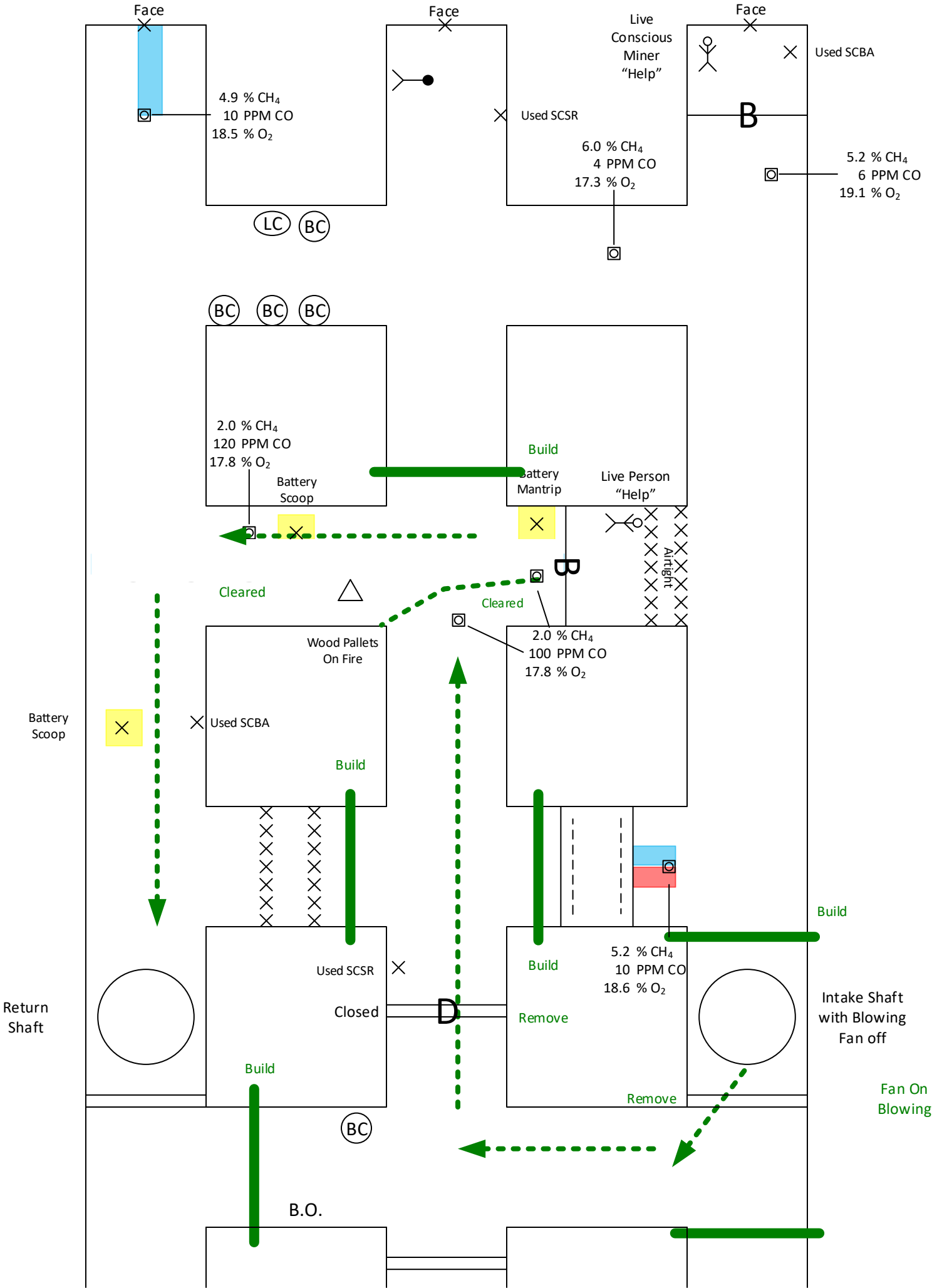

VENT 2

